



Barry Lawrence Ruderman Antique Maps Inc.

7407 La Jolla Boulevard
La Jolla, CA 92037

www.raremaps.com

(858) 551-8500
blr@raremaps.com

[Wetmore & Sanborn's Addition / Mount Hope Cemetery Central Park Addition] Plat of Cemetery Road (Imperial Avenue)

Stock#: 96533
Map Maker: Capps
Date: 1898
Place: San Diego
Color: Pen & Ink with Wash Color
Condition: VG
Size: 33.5 x 12 inches
Price: \$ 345.00

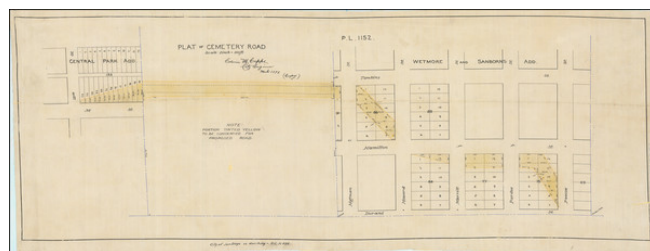

Description:

Detailed map of a the proposed route (in Yellow) identifying the road leading the the future Mount Hope Cemetery, drawn by San Diego City Engineer Edwin Capps.

The map shows the area from today's 32nd Street to Pascoe Street (36th) on the edge of the cemetery, which had been founded in 1869.

Detailed Condition:

Pen & Ink on drafting linen.