



Barry Lawrence Ruderman Antique Maps Inc.

7407 La Jolla Boulevard
La Jolla, CA 92037

www.raremaps.com

(858) 551-8500
blr@raremaps.com

(Murray Hill / Manhattan) Map of Land in the 16th Ward of the City of New York belonging to the Heirs of John Murray Esqr.

Stock#: 59279
Map Maker: Spielmann & Brush
Date: 1881
Place: Hoboken, NJ
Color: Hand Colored
Condition: Fair
Size: 26 x 36 inches
Price: \$ 375.00

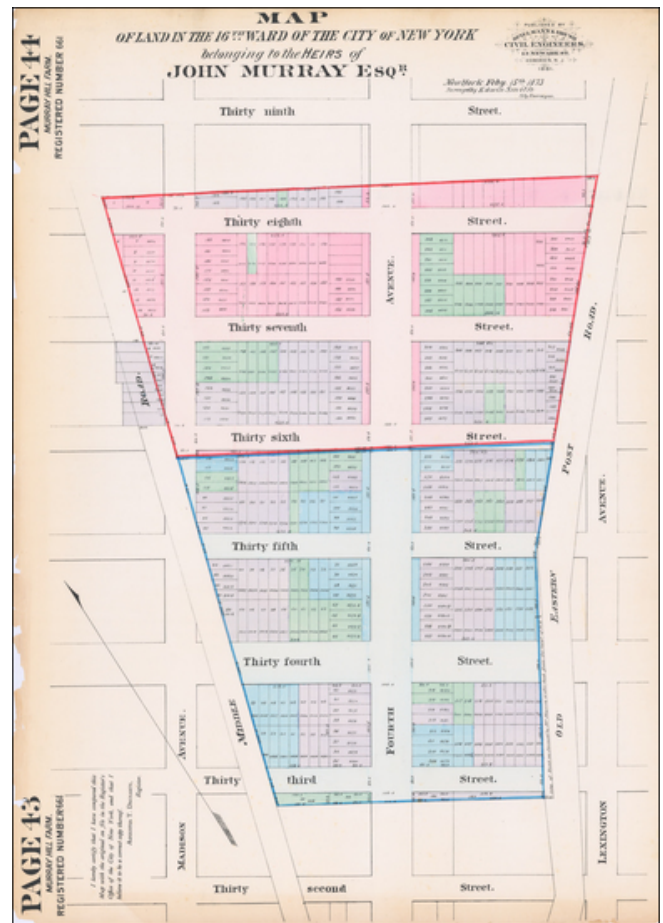

Description:

Hand-colored lithographed map of Murray Hill, New York City, published by Spielmann & Brush in their very rare atlas *Certified Copies of Original Maps of Property in New York City* (1881).

Centered on Park Avenue between 32nd to 39th, the area shown currently includes the Morgan Library, Consulate General of Mexico, Consulate-General of Poland, Consulate General of El Salvador, Philatelic Foundation, Scandinavia House, etc.

The map shows old farm plots and roads, as well as modern streets and lots, bounded by Madison Avenue, Lexington Avenue, 32nd Street, and 39th Street.



**Barry Lawrence Ruderman
Antique Maps Inc.**

7407 La Jolla Boulevard
La Jolla, CA 92037

www.raremaps.com

(858) 551-8500
blr@raremaps.com

**(Murray Hill / Manhattan) Map of Land in the 16th Ward of the City of New York
belonging to the Heirs of John Murray Esqr.**

Detailed Condition:

Banknote paper. Some edgewear, particularly at the left side.