



# Barry Lawrence Ruderman Antique Maps Inc.

7407 La Jolla Boulevard  
La Jolla, CA 92037

www.raremaps.com

(858) 551-8500  
blr@raremaps.com

## Wilshire Terrace Southeast Corner Wilshire Boulevard and Cahuenga Ave. . . .

**Stock#:** 47851  
**Map Maker:** Anonymous  
**Date:**  
**Place:** Los Angeles  
**Color:** Uncolored  
**Condition:** VG  
**Size:** 25 x 14 inches  
**Price:** SOLD

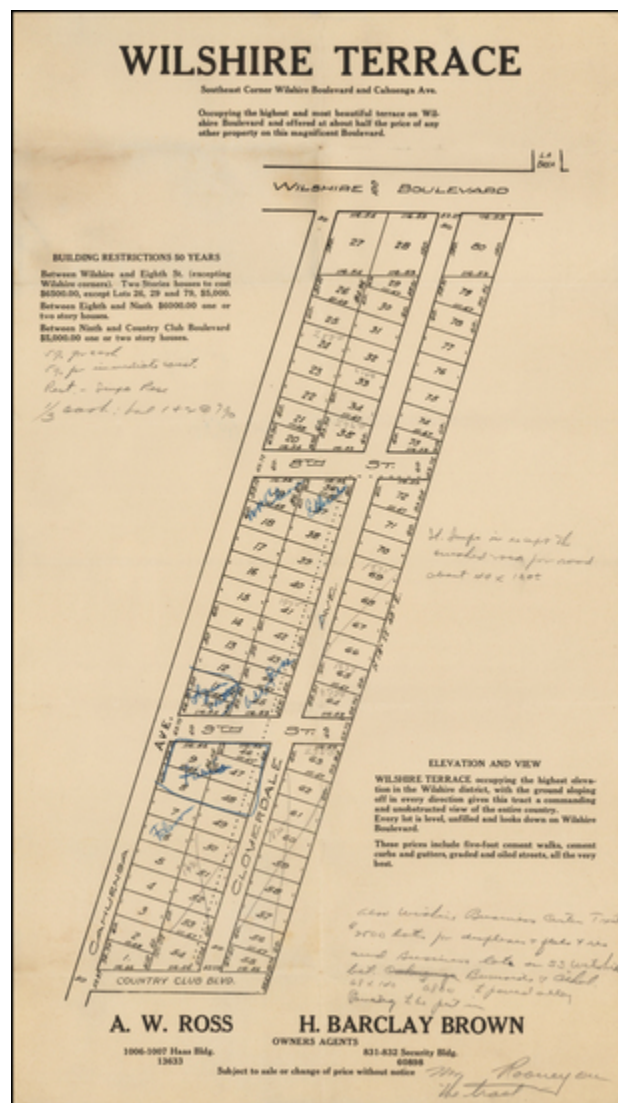

### Description:

Interesting early subdivision map of Wilshire Terrace, with extensive manuscript annotations.

Wilshire Terrace is described as:

*Occupying the highest and most beautiful terrace on Wilshire Boulevard and offered at about half the price of any other property on this magnificent Boulevard.*



**Barry Lawrence Ruderman  
Antique Maps Inc.**

7407 La Jolla Boulevard  
La Jolla, CA 92037

[www.raremaps.com](http://www.raremaps.com)

(858) 551-8500  
[blr@raremaps.com](mailto:blr@raremaps.com)

---

**Wilshire Terrace Southeast Corner Wilshire Boulevard and Cahuenga Ave. . . .**

One of the agents listed was A.W. Ross, who would go on to develop the Miracle Mile.

The annotations include financing terms, the names of some early purchasers and other notes in a contemporary hand, including a reference to "Mr. Rooney" at the bottom right corner.

**Detailed Condition:**