



# Barry Lawrence Ruderman Antique Maps Inc.

7407 La Jolla Boulevard  
La Jolla, CA 92037

www.raremaps.com

(858) 551-8500  
blr@raremaps.com

## Prescott and Eastern R.R. Sketch showing Located and Proposed Tracks also Right of way and other information. Humboldt, Ariz. . . .

**Stock#:** 31898  
**Map Maker:** Santa Fe Railroad  
**Date:** 1905  
**Place:** Prescott, AZ  
**Color:** Color  
**Condition:** VG+  
**Size:** 18 x 21 inches  
**Price:** \$ 275.00

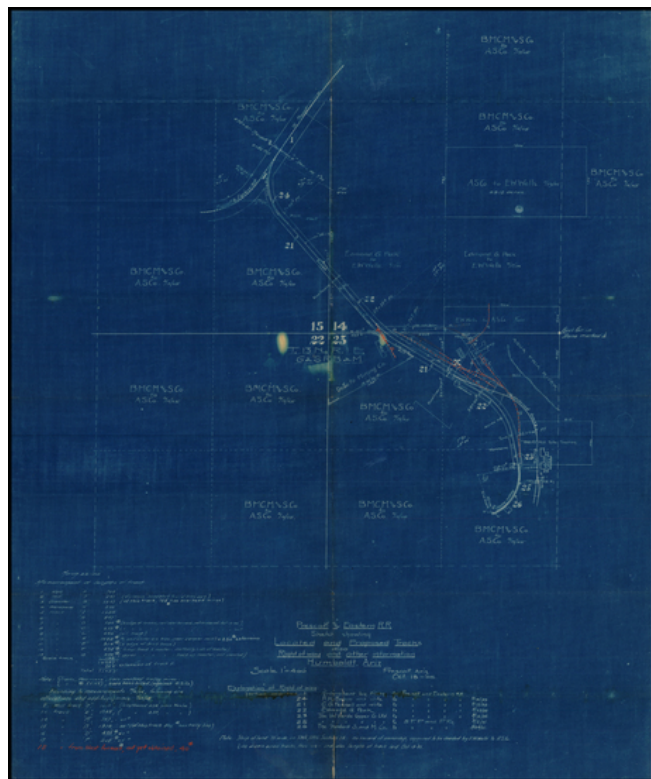

### Description:

Internal working Sketch map showing the existing and proposed routes of the Prescott & Eastern Railroad in the vicinity of Humboldt, Arizona, prepared on October 18, 1905.

Most of the land in the areas is shown as being owned by E.W. Wells and the AS Co. The Wells Mill Site is located, as is an abandoned trunk of rail near the Agua Fria River.

The lands of the De Soto Mining Co. are also shown.

### Detailed Condition: