



Barry Lawrence Ruderman Antique Maps Inc.

7407 La Jolla Boulevard
La Jolla, CA 92037

www.raremaps.com

(858) 551-8500
blr@raremaps.com

Map of the Town of Sespe Ventura Co. Cal.

Stock#: 31578df
Map Maker: Southern Pacific Railroad
Company
Date: 1900 circa
Place: Los Angeles
Color: Uncolored
Condition: VG
Size: 15 x 12 inches
Price: SOLD

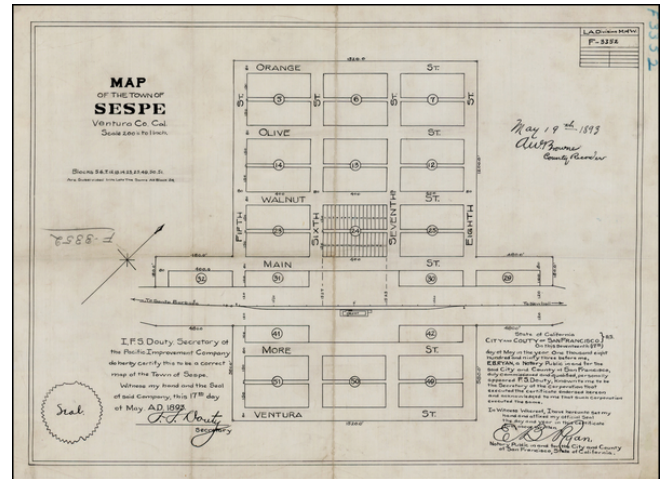

Description:

Detailed plan of Sespe, a town on the Southern Pacific Railroad line between Newhall and Santa Barbara, near Fillmore.

Rancho Sespe was a 8,881-acre Mexican land grant in present day Ventura County, California given in 1833 by Governor José Figueroa to Carlos Antonio Carrillo. The grant encompassed the Santa Clara River Valley between Piru Creek on the east and Santa Paula Creek on the west, and was bounded to the north and south by the mountains, and included present day Fillmore.

Detailed Condition: