



Barry Lawrence Ruderman Antique Maps Inc.

7407 La Jolla Boulevard
La Jolla, CA 92037

www.raremaps.com

(858) 551-8500
blr@raremaps.com

Map of Western - Melrose Business Place to be known as Tract No. 3783 when recorded

...

Stock#: 30070
Map Maker: Engineering Service Company
Date: 1920 circa
Place: Los Angeles
Color: Uncolored
Condition: VG
Size: 17 x 22 inches
Price: SOLD

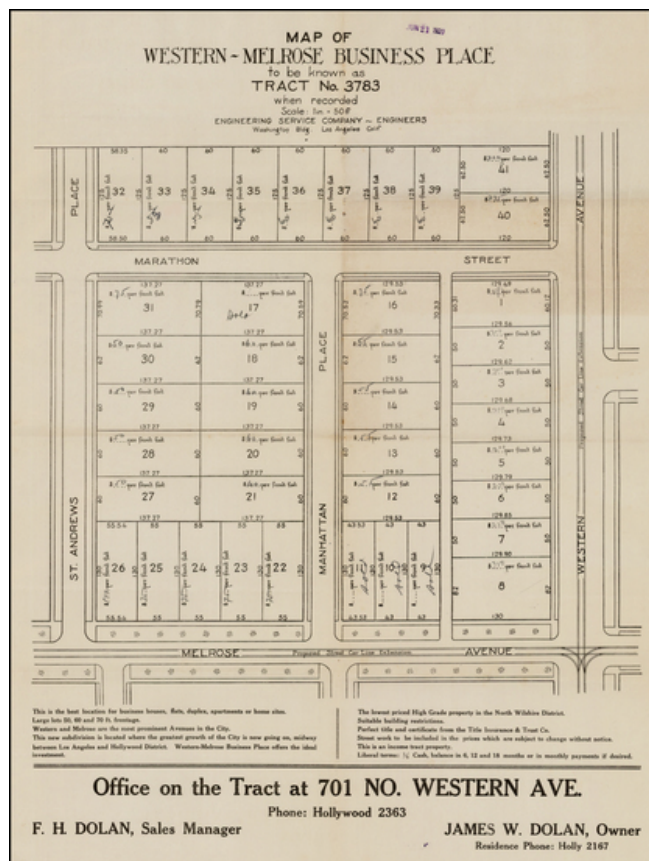

Description:

Detailed Tract map of the land bounded by Marathon in the North, Melrose Avenue in the South, St. Andrews to the West and Western Blvd to the east, showing the the Western - Melrose Business Place.

The map was apparently owned by Walter McKee, a Los Angeles Real Estate figure, who has noted the cost of each lot on a square foot basis and the lot sales on the map.

The map discusses the benefits of ownership in the area, financing terms and other details. James W. Dolan is listed as the Owner, with F. H. Dolan the Sales Manager.

Detailed Condition:

Drawer Ref:

Stock#: 30070



**Barry Lawrence Ruderman
Antique Maps Inc.**

7407 La Jolla Boulevard
La Jolla, CA 92037

www.raremaps.com

(858) 551-8500
blr@raremaps.com

Map of Western - Melrose Business Place to be known as Tract No. 3783 when recorded

...

Includes pencil annotations